

POWER SMOKELESS GRILL™

Before You Begin

It is very important that you read this entire manual, ensuring that you are totally familiar with its operation and precautions.

ALWAYS make sure to follow the instructions and assemble the Power Smokeless Grill in the correct order.

Each time the Power Smokeless Grill is used, it **MUST** be assembled this way to ensure that it functions correctly and keeps the Power Smokeless Grill in optimal condition.

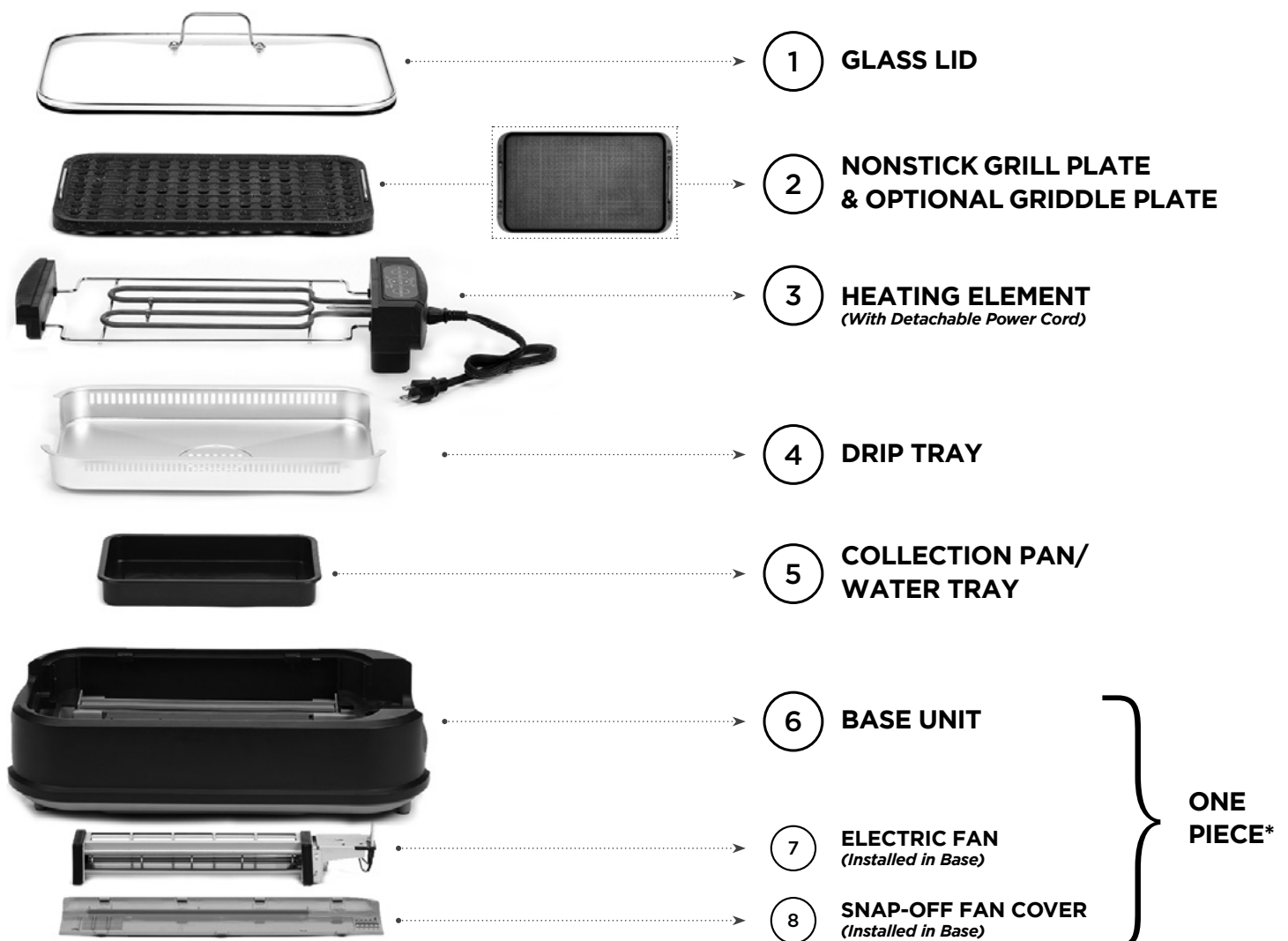

Assembly Instructions

1. Place the appliance on a stable, level, horizontal, and heat-resistant surface.

NOTE: The color of the interior of the Unit may vary depending on the model.

Step 1



2. Place the water tray in place inside the appliance. ALWAYS make sure to add about 2 cups of water to the water tray before using the Power Smokeless Grill.

Step 2



3. Place the drip tray on the appliance. ALWAYS make sure that the arrows on the drip tray are pointing towards the opening where the control panel will be placed.

Step 3



Assembly Instructions

4. Place the heating element in the unit.

Step 4



5. Place the grill or griddle plate on the heating element.

Step 5



6. Place the lid on top of the unit.

Step 6



Assembly Instructions

7. Plug the female end of the power cord into the control panel and the male end of the power cord into an outlet. Use the control panel to turn on the appliance and control the fan and temperature on the Power Smokeless Grill.

Step 7



When assembling the Power Smokeless Grill, **NEVER** place the heating element in the appliance without putting the drip tray in first.

RIGHT



WRONG



Failure to correctly assemble the Power Smokeless Grill can result in damage to your product.



Distributed by:
Tristar Products, Inc.
Fairfield, NJ 07004
© 2019 Tristar Products, Inc.
Made in China

PSG_ASSEMBLY_INSERT_TP_ENG_V1_19XXXX