

## STEP 1



Disassemble the packed parts and remove all packaging materials.

## STEP 2



Ensure that the Water Tray is in place and fill with about 2 cups of water.

## STEP 3



Reassemble the parts in the same order they were packaged ***(see reverse side for detailed instructions)***.

## STEP 4



Attach the Power Cord to the Base Unit and then plug the Power Cord into an outlet.

## STEP 5



Press the Power Button and then the Fan Button. Set the temperature to a medium or high heat setting for 4–6 mins. to preheat the grill. Then, set the desired cooking temperature and add your food!

**Unpack all parts from the box and remove any clear or blue protective film on the components. Wash with warm soapy water before first use (only select accessories are dishwasher safe).**

# Assembly

SAVE THESE INSTRUCTIONS

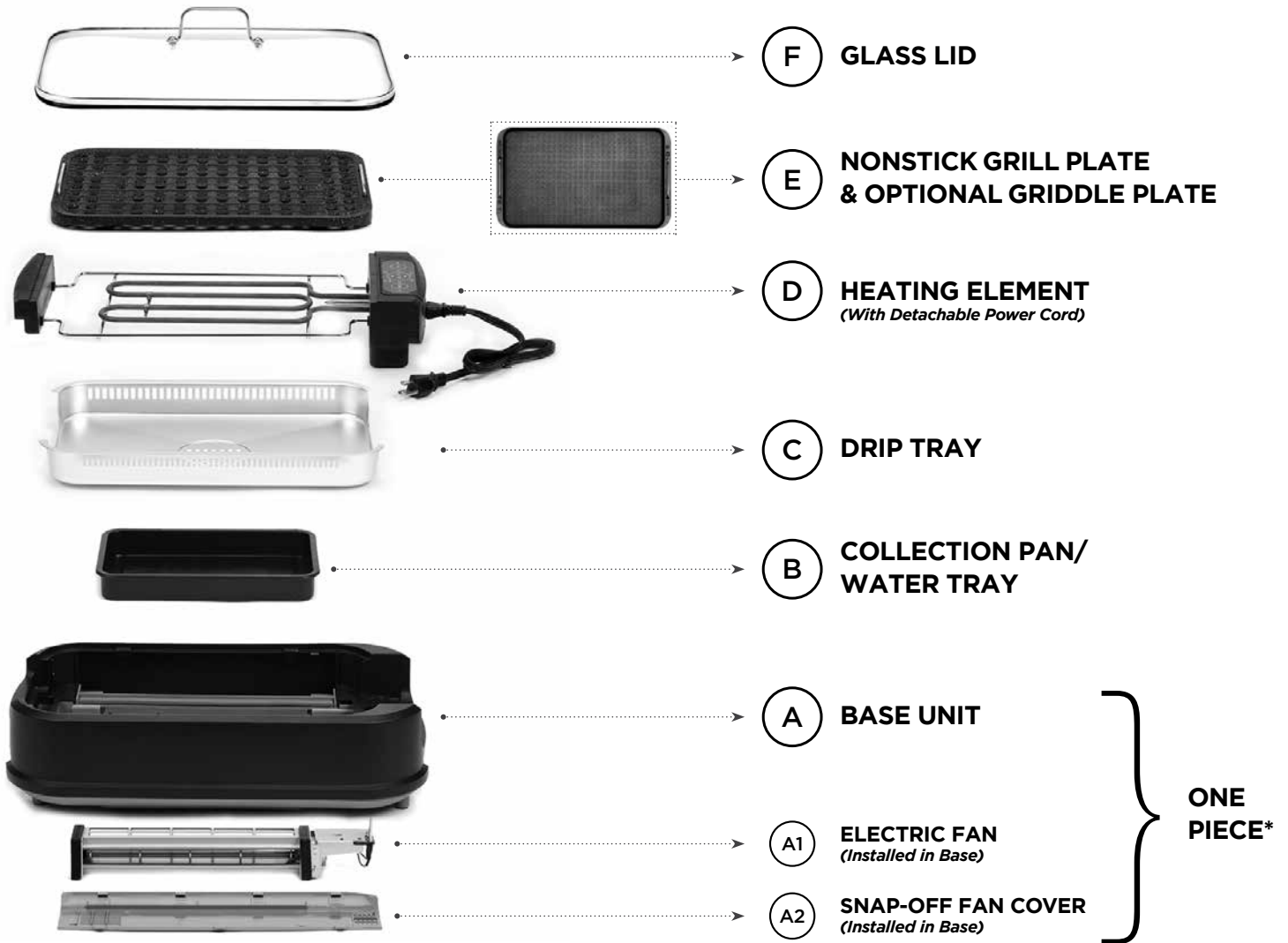

1. Place the Base Unit (A) on a stable, level surface.
2. Place the Collection Pan/Water Tray (B) inside the center of the Base Unit (A).
3. Place the Drip Tray (C) on top of the Collection Pan/Water Tray (B) inside the Base Unit (A).
4. Place the Heating Element (D) on top of the Drip Tray (C). Align the arrows on the Drip Tray (C) with the arrows on the Base Unit (A).
5. Place either the Grill Plate or Griddle Plate (E) on top of the Heating Element (D).

6. When cooking with the Glass Lid (F), place the Glass Lid (F) over the Grill Plate or Griddle Plate (E).

**\*NOTE:** The removable Electric Fan (A1) and Snap-Off Fan Cover (A2) are already installed in the Base Unit (A). If you are thoroughly cleaning the Base Unit (A) with water and detergents, remove the Electric Fan (A1) first. See **Removing the Electric Fan** in the owner's manual for detailed instructions.