

Quick Start Guide

PowerXL™ *products that excel* **SMOKELESS GRILL ELITE™**

See owner's manual for complete instructions and important safety information before using this product.

IMPORTANT: Unpack all parts from the box and remove any clear or blue protective film on the components. Wash accessories with warm, soapy water before first use (only select accessories are dishwasher safe).

STEP 1

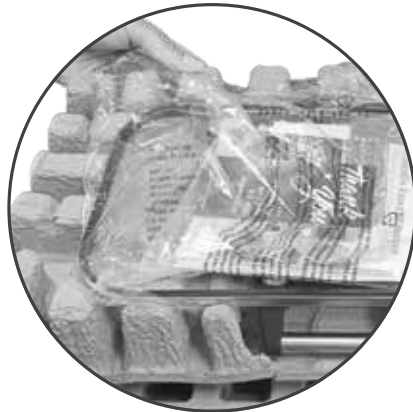

Disassemble the packed parts and remove all packaging materials. Wash all parts with mild dish soap and water. Dry the parts before use. Reassemble the parts in the same order they were packaged (*see reverse side for detailed instructions*).

STEP 2



Ensure that the Water Tray is in place and fill with about $\frac{3}{4}$ cup of water.

STEP 3



Attach the Power Cord to the Base Unit and then plug the Power Cord into an outlet.

STEP 4



Press the Power Button and then the Fan Button. Set the temperature to a medium or high heat setting for 4-6 mins. to preheat the grill. Then, set the desired cooking temperature and add your food!

Assembly

SAVE THESE INSTRUCTIONS

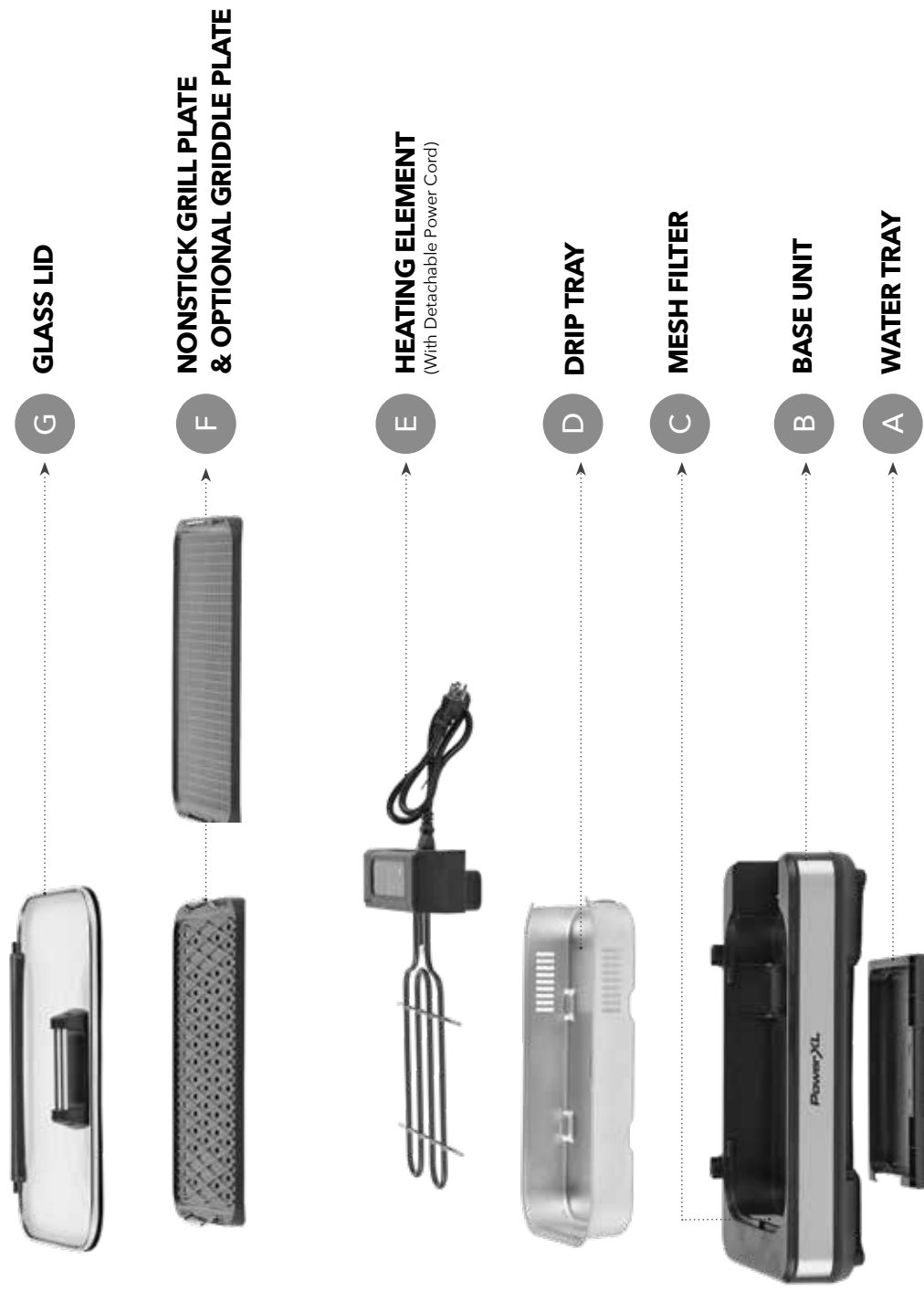

1. Place the Base Unit (B) on a stable, level surface.
2. Slide the Water Tray (A) into the Base Unit (B).
3. Place the Drip Tray (D) inside the Base Unit (B). Align the arrows on the Drip Tray (D) with the arrows on the Base Unit (B).
4. Place the Heating Element (E) on top of the Drip Tray (D).
5. Place either the Grill Plate or Griddle Plate (F) on top of the Heating Element (E).
6. When cooking with the Glass Lid (G), lower the Glass Lid (G) over the Grill Plate or Griddle Plate (F).