

PowerXL
products that excel

SMART BREW



Owner's Manual

SAVE THESE INSTRUCTIONS – FOR HOUSEHOLD USE ONLY

MODEL: CM917

When using electrical appliances, basic safety precautions should always be followed. Read this manual thoroughly before using this appliance.



IMPORTANT SAFEGUARDS

WARNING

PREVENT INJURIES! CAREFULLY READ ALL INSTRUCTIONS BEFORE USE!

When using electrical appliances, basic safety precautions should be followed, including the following:

- READ ALL INSTRUCTIONS.
- NEVER immerse the appliance, which contains electrical components and heating elements, in water. Do not rinse under the tap.
- The appliance is not intended for use by people with reduced physical, sensory, or mental capabilities or lack of experience and knowledge unless they are under the supervision of a responsible person or have been given proper instruction in using the appliance. This appliance is not intended for use by children.
- Close supervision is necessary when any appliance is used by or near children.
- Do not use this appliance for anything other than its intended use.
- To protect against electric shock, do not place the power cord, plug, or appliance in water or other liquids.
- Do not plug in the power cord or operate the appliance controls with wet hands.
- Do not let the power cord hang over the edge of a table or counter or touch hot surfaces.
- This appliance has a polarized plug (one blade is wider than the other). To reduce the risk of electric shock, this plug is intended to fit into a polarized outlet only one way. If the plug does not fit fully into the outlet, reverse the plug. If it still does not fit, contact a qualified electrician. Do not attempt to modify the plug in any way.
- Do not plug the power cord into an electrical outlet until you are ready to operate the appliance. To disconnect, press the ON/OFF Button to turn the appliance off and then remove the plug from the electrical outlet.
- Ensure the appliance is properly plugged into a dedicated wall outlet without any other appliances on the same outlet.
- Unplug the appliance from the electrical outlet when either the appliance or its display clock is not in use and before cleaning. Allow to cool before putting on or taking off parts and before cleaning the appliance.
- Do not use outdoors.
- Do not place the appliance on or near a hot gas or electric burner or in a heated oven.
- Do not overfill the Water Tank or the Filter Holder.
- The Carafe's lid must always be attached to the Carafe before brewing coffee. The Water Tank Lid, Coffee Bean Box Lid, and Holder Cover must all be closed before brewing coffee.
- Do not operate any appliance with a damaged power cord or plug or after the appliance malfunctions or has been damaged in any manner. Contact Customer Service for examination, repair, or adjustment.
- This appliance should be serviced only by qualified service technicians. Contact Customer Service using the information located on the back of this manual.
- Do not place cloth (or other flammable materials) or otherwise restrict airflow beneath the appliance.
- Before using your new appliance on any countertop surface, check with your countertop manufacturer or installer for recommendations about using appliances on your surfaces. Some manufacturers and installers might recommend protecting your surface by placing a hot pad or trivet under the appliance for heat protection. Your manufacturer or installer might recommend that hot pans, pots, or electrical appliances should not be used directly on the countertop. If you are unsure, place a trivet or hot pad under the appliance before using it.

IMPORTANT SAFEGUARDS

- Do not place your appliance on a cooktop, even if the cooktop is cool, because you could accidentally turn the cooktop on, causing a fire, damaging the appliance, the cooktop, and your home.
- Do not touch hot surfaces. Use handles of knobs.
- Use caution when moving an appliance or container with hot liquids.
- Do not clean the carafe or heating plate with cleansers, steel wool pads, or other abrasive materials.
- Do not operate your appliance in an appliance garage. When storing in an appliance garage, always unplug the appliance from the electrical outlet. Not doing so could create a risk of fire, especially if the appliance touches the walls of the garage or the door touches the appliance as it closes.
- Do not fill the Water Tank with anything other than water except when descaling the Water Tank as outlined in the “Descaling the Coffee Maker” section.
- Check the hopper (the Coffee Bean Box) for the presence of foreign objects before using.
- The Carafe is designed for use with this appliance. The Carafe must never be used on a range top.
- Do not set the hot Carafe on a wet or cold surface.
- Do not use the Carafe if it is cracked or has a loose or weakened handle.
- Turn the appliance OFF and then unplug it from the outlet when not in use, before assembling or disassembling parts, and before cleaning. To unplug, grasp the plug and pull from the outlet. Never pull from the power cord.
- Do not clean the Carafe with cleansers, steel wool pads, or other abrasive materials.
- The use of accessories not evaluated for use with this appliance may cause injuries.
- **WARNING:** To reduce the risk of fire or electric shock, do not remove the base panel. No user-serviceable parts are inside. Repairs should be performed only by authorized personnel.
- Avoid contacting moving parts. Do not attempt to defeat any safety interlock mechanisms.
- A short power-supply cord is provided to reduce risks resulting from becoming entangled in or tripping over a longer cord. Extension cords can be used if care is exercised in their use. If an extension cord is used:
 - The marked electrical rating of the extension cord should be at least as great as the electrical rating of the appliance.
 - The longer cord should be arranged so that it will not drape over the countertop or tabletop, where it can be pulled by children or tripped over.
- Clogging or backing up of water and/or coffee in the Filter Holder can occur under any or a combination of the following conditions: the use of too finely ground coffee, not properly cleaning coffee grounds from the Filter Holder, or allowing coffee grounds to spill over the Filter Basket.
- **CAUTION:** Do not open the Filter Slot during the brewing process even if no water is draining from the Filter because extremely hot water/coffee can spill out and cause injury. If water/coffee is not draining from the Filter during the brewing cycle, unplug the appliance and wait 10 minutes before opening and checking the Filter Holder.



WARNING:

For California Residents

This product can expose you to chemicals including Di(2-ethylhexyl)phthalate, which is known to the State of California to cause cancer and birth defects or other reproductive harm. For more information, go to www.P65Warnings.ca.gov.

SAVE THESE INSTRUCTIONS - FOR HOUSEHOLD USE ONLY

Parts & Accessories

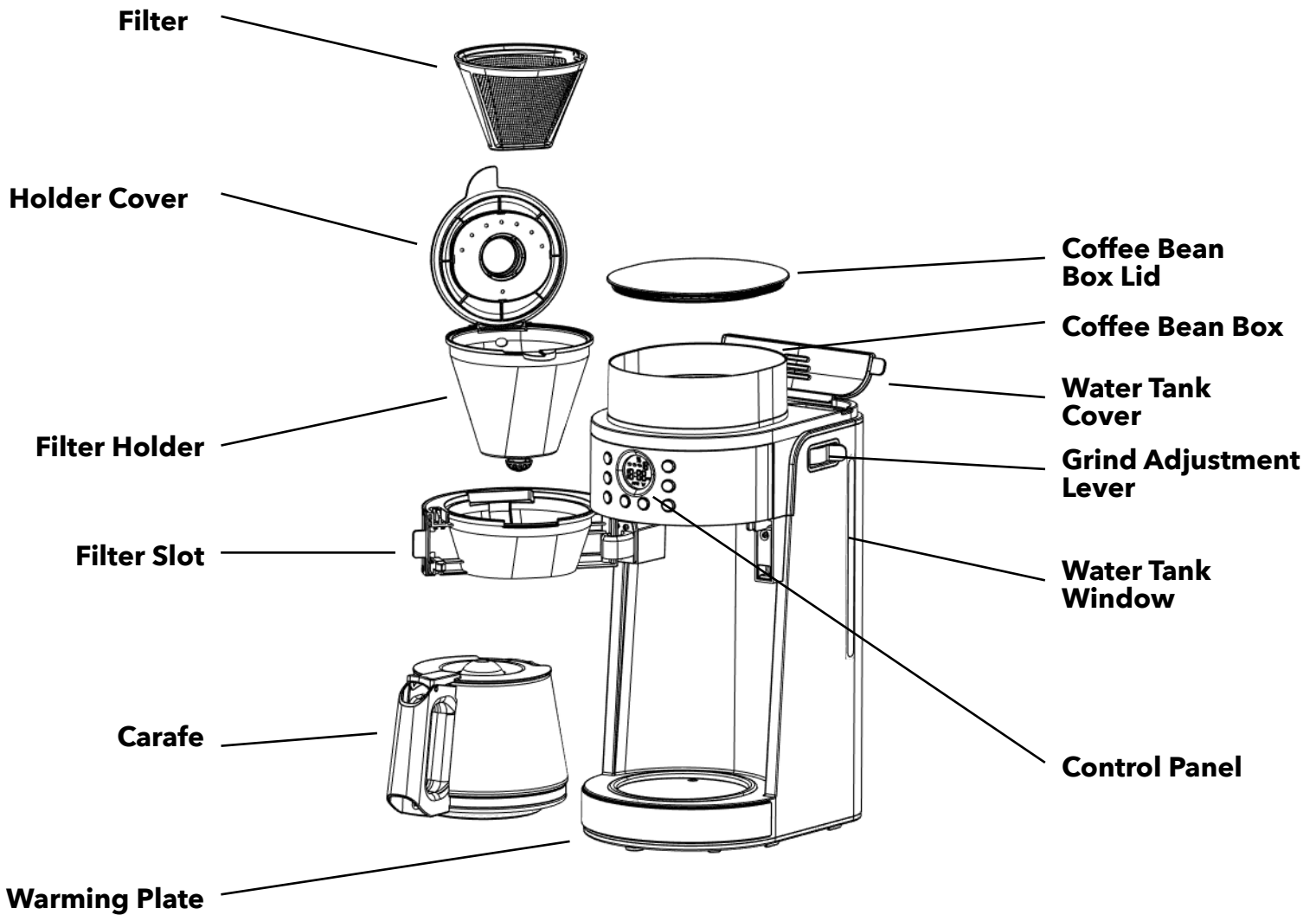

Appliance Specifications	
Model Number	CM917
Supply Power	120V~60 Hz
Rated Power	1000W
External Dimensions	10.2 x 7.7 x 16.5 inches (260 x 195 x 420 mm)
Unit Weight	6.6 lb (3 kg)

The Control Panel



ON/OFF Button: Once the appliance is plugged in, press to turn the appliance on or off.

CUP Button: Press to set the number of cups of coffee you are brewing. The number at the top right of the display panel will show the number of cups of coffee you select. Use the markings on the Water Tank Window to ensure that the water you add to the Water Tank matches the number of cups of coffee being brewed.

STRENGTH Button: Press to set the strength of the coffee you are brewing. The ☐ icons on the display panel will illuminate to show the selected coffee strength level (1-3).

PROG Button: Press and then use the HR Button and MIN Button to set a time to start brewing coffee. The coffee's digital clock must be set before attempting to program a delayed brew time (see the "Setting a Delay Timer" section). When the delay timer is set, the "AUTO" icon will illuminate on the display panel.

HR Button: Press to adjust the appliance's digital clock hour setting. The "PM" icon will illuminate on the display panel to indicate that the digital clock is being set after 12 pm. After pressing the PROG Button, press to adjust the hour setting of the brew time.

MIN Button: Press to adjust the appliance's digital clock minute setting. After pressing the PROG Button, press to adjust the minute setting of the brew time.

GRIND OFF Button: Press to disable the grind function during the brewing process (use with pre-ground coffee). When the grind setting is disabled, the ☐ icon will disappear.

BREW Button: Press to start brewing coffee.

Instructions for Use

Before First Use

1. Unpack all parts from the box and remove any clear or blue protective film on the components. Check all packaging material thoroughly for accessories. Wash any accessories with warm, soapy water before first use (only select accessories are dishwasher safe).
2. Remove and save all literature.
3. Wash the Filter, Filter Holder, and Carafe (see the "Care & Cleaning" section). Return the parts to the appliance.
4. Open the Water Tank Lid. Add water to the Water Tank. Do not exceed the "10" line in the Water Tank.
5. Plug the appliance's power cord into an electrical outlet. Press the ON/OFF Button to turn the appliance on.
6. Press the GRIND OFF Button once to set the grind setting to off.
7. Press the BREW Button. The appliance will heat the water and clean the Water Tank and internal water tubes.
8. Repeat 1-2 times before using the appliance to brew coffee.

General Operating Instructions

Grinding Coffee Beans and Brewing Coffee

1. Open the Water Tank Lid. Measure water according to the number of cups of coffee desired (see **Fig. A**). Do not exceed the "10" line in the Water Tank. Note that all the water in the Water Tank will be consumed when brewing coffee, so do not add more water than needed to make your desired cups of coffee.
2. Open the door on the appliance. Place the Filter in the Filter Holder (a paper filter can be used instead). Close the door. Note that this door must be closed or the appliance will not be able to brew coffee.
3. Open the Coffee Bean Box Lid. Add a maximum of 7 oz (200 g) coffee beans to the Coffee Bean Box. Close the Coffee Box Lid.
4. Ensure the Carafe is in position with the Carafe's lid on the Carafe before brewing coffee.
5. Plug the appliance's power cord into an electrical outlet. Press the ON/OFF Button.
6. Press the CUP Button to program the number of cups of coffee you are brewing.
7. Press the STRENGTH Button to adjust the strength of your coffee.
8. You can use the Grind Adjustment Lever on the side of the appliance to adjust the coarseness of your coffee beans (see **Fig. B**). For most uses, the medium setting is recommended.
9. Press the BREW Button. The appliance will automatically grind and then brew the coffee beans. You can press the ON/OFF Button or the BREW Button to cancel the grinding and brewing process at any time. Note that the coffee strength and number of cups cannot be adjusted during the brewing process.
10. When the appliance is done brewing coffee, it will beep five times. The heat icon (☰) on the display panel will illuminate, indicating that the appliance is keeping your coffee warm for 2 hours. After 2 hours, the appliance will beep two times and shut down automatically. If you do not need the appliance to keep your coffee warm, you can press the ON/OFF Button or the BREW Button to stop the appliance from warming your coffee.
11. Allow the appliance to cool. Then, check and clean ground coffee residue out of the Filter after each use.

Instructions for Use

Brewing Pre-Ground Coffee

1. Open the Water Tank Lid. Measure water according to the number of cups of coffee desired (see **Fig. A**). Do not exceed the "10" line in the Water Tank. Note that all the water in the Water Tank will be consumed when brewing coffee, so do not add more water than needed to make your desired cups of coffee.
2. Open the door on the appliance. Place the Filter in the Filter Holder (a paper filter can be used instead). Add a maximum of 3.2 oz (90 g) ground coffee to the Filter. Close the door. Note that this door must be closed or the appliance will not be able to brew coffee.
3. Ensure the Carafe is in position with the Carafe's lid on the Carafe before brewing coffee.
4. Plug the power cord into an electrical outlet. Press the ON/OFF Button to turn the appliance on.
5. Press the GRIND OFF Button to disable the grind function. The ☒ and ☐ icons should not appear on the display.
6. Press the CUP Button to program the number of cups of coffee you are brewing.
7. Press the BREW Button. With the grind function disabled, the appliance will begin brewing the ground coffee. You can press the ON/OFF Button or the BREW Button to cancel the brewing process at any time. Note that the number of cups cannot be adjusted during the brewing process.
8. When the appliance is done brewing coffee, it will beep five times. The heat icon (☼) on the display panel will illuminate, indicating that the appliance is keeping your coffee warm for 2 hours. After 2 hours, the appliance will beep two times and shut down automatically. If you do not need the appliance to keep your coffee warm, you can press the ON/OFF Button or the BREW Button to stop the appliance from warming your coffee.
9. Allow the appliance to cool. Then, check and clean ground coffee residue out of the Filter after each use.

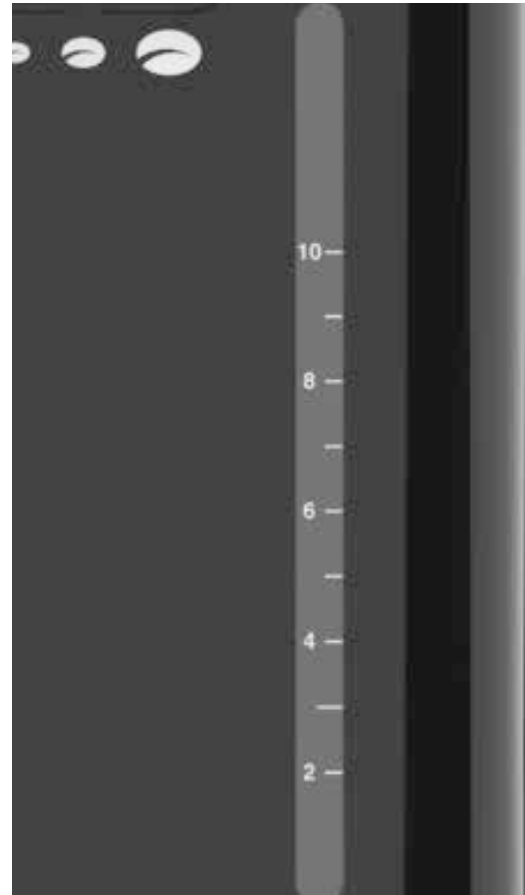

Fig. A. The Water Tank Window. Each number represents a number of cups of coffee. Do not fill past the "10" line.



Fig. B. The Grind Adjustment Lever. The larger setting gives you more coarsely ground coffee, while the smaller setting gives you more finely ground coffee.

Instructions for Use

Delay Timer

You can set your appliance to brew coffee later:

1. If the appliance's digital clock has not yet been set, use the HR and MIN Buttons to set the current time.
2. Prepare the appliance with coffee beans or pre-ground coffee and water. Set the number of cups of coffee and the brew strength.
3. Press the PROG Button. Use the HR and MIN Buttons to set a time that the appliance will begin making coffee. Note that the "PM" symbol on the display panel illuminates when the time is set to the afternoon. Otherwise, the timer is set to the morning.
4. Press the PROG Button to brew coffee at the set time. The "AUTO" icon on the display panel will illuminate. If you want to cancel the timer, press the PROG Button again.

Anti-Drip Feature

This appliance is equipped with an anti-drip feature that lets you remove the Carafe during the brewing process without spilling coffee. When you remove the Carafe, coffee will stop dripping from the appliance temporarily without interrupting the brewing process.

You must return the Carafe to the appliance within 20 seconds of removing the Carafe or water will start to overflow from the Filter Slot.

Brewing the Ideal Coffee

There are four main components of an ideal cup of coffee:

1. **WATER QUALITY:** Coffee is 98% water. This means that water quality plays a huge part in the quality of your coffee. For best results, use filtered water to remove impurities, odors, and chlorine from your tap water.
2. **COFFEE BEANS:** The flavor in coffee comes from the coffee beans. The freshest beans tend to taste the best, so for best results, brew fresh coffee beans within two weeks of buying them.
3. **GRINDING:** A coffee bean's flavor degrades quickly once the bean is broken, so coffee should be brewed soon after grinding coffee beans. This appliance's grinder is designed to release more of the oils and flavors that create the best-tasting coffee.
4. **PROPORTION:** To avoid making coffee that is too weak or too strong, you should use the right proportion of coffee to water. If you are using pre-ground coffee, start by using 1 tbsp. ground coffee or whole beans per cup of coffee and make adjustments based on your preferences.

Care & Cleaning

Cleaning the Appliance

1. Let the appliance cool completely before cleaning.
2. Clean the appliance after each use. Always turn the appliance off and unplug it before cleaning.
3. After each use, remove the Filter and Filter Holder and discard any coffee grounds.
4. Remove the Carafe and pour out any remaining coffee.
5. Use a wet cloth to clean the powder outlet on the appliance. Dry completely.
6. Wash any parts in warm, soapy water and then rinse thoroughly. Dry the parts completely before returning them to the appliance.

Descaling the Coffee Maker

With regular use, minerals and hard water can clog your coffee maker. A full cleaning with vinegar is recommended once a month or every 60 brew cycles. This appliance has a descaling reminder function. When the backlight of the display panel flashes during the brewing process, you should descale the appliance:

1. Pour equal amounts of water and white vinegar into the Water Tank until the "10" line is reached. **NOTE:** Only use white vinegar.
2. Remove any coffee beans or pre-ground coffee from the Coffee Bean Box.
3. Open the door on the appliance. Place the Filter in the Filter Holder. Close the door.
4. Ensure the Carafe is in position.
5. Plug the appliance's power cord into an electrical outlet. Press the ON/OFF Button to turn the appliance on.
6. Press the GRIND OFF Button to disable the grind function. Press the CUP Button to set the number of cups to 10.
7. Press the BREW Button. When about half of the solution has been brewed, press the ON/OFF Button or the BREW Button to cancel the brewing function.
8. Let the appliance sit for 30 minutes to allow the vinegar to break down any internal limescale or calcium.
9. Repeat the process once more with another 10-cup brew to use up the remaining solution in the Water Tank.
10. Once both brewing cycles are complete, discard the vinegar.
11. To flush out all traces of vinegar, run the appliance with fresh water three times. Fill the Water Tank to the "10" line with water and repeat steps 3-7. Discard and replace the water after each brewing cycle and repeat until all the vinegar is flushed out of the appliance.

NOTE: To cancel the descaling reminder, press any button. If the appliance is not descaled before using the appliance to brew coffee, the descaling reminder will activate again.

Storage

1. Unplug the appliance and let cool for at least 30 minutes before storing.
2. Clean the appliance (see the "Cleaning the Appliance" section). Ensure all the components are dry before storing.
3. Store in a clean, dry place.

Maintenance

Any other maintenance must be performed by an authorized service technician. Contact customer service using the information on the back of this manual for more information.

Troubleshooting

Troubleshooting		
Problem	Possible Cause	Solution
The appliance will not power on.	The appliance is not plugged in.	Plug the appliance into a dedicated electrical outlet.
	The door covering the Filter Holder is not closed.	Close the door covering the Filter Holder.
The appliance will not brew coffee.	The Filter has not been cleaned.	Clean any leftover coffee grounds out of the Filter after each use.
The appliance is not grinding beans.	The Coffee Bean Box might be too full.	Turn the appliance off. Remove some of the coffee beans or pre-ground coffee from the Coffee Bean Box.
Coffee is weaker than usual.	There are not enough coffee beans or pre-ground coffee in the Coffee Bean Box.	Ensure there are enough coffee beans or pre-ground coffee in the Coffee Bean Box before brewing coffee.
There is coffee sediment in brewed coffee.	The coffee beans were ground too finely or too much coffee was used.	Increase the coffee grind size, use a paper filter instead of the permanent filter, and/or decrease the coffee amount and strength.
Coffee overflows out of the brewing basket.	The coffee beans were ground too finely, too much coffee was used, or the paper filter was not placed correctly.	Increase the coffee grind size, ensure that the paper filter fits flat against the Filter Holder's walls, and/or decrease the coffee amount and strength.
The appliance is brewing coffee too slowly, produces excessive steam, or does not brew all the water in the Water Tank.	The appliance needs to be cleaned.	Clean the appliance according to the instructions in the "Descaling the Coffee Maker" instructions. For severe build-up, multiple cleaning cycles might be needed.

Error Codes		
Error Code	Meaning	Solution
E4	The appliance needs to be cleaned and/or descaled.	Follow the cleaning and descaling instructions in the "Care & Cleaning" section.
E6*	Filter Slot has not been cleaned.	Clean the Filter Slot.
E8	The door on the front of the appliance has not been closed properly.	Ensure the door on the front of the appliance is fully closed.
Other Error Codes	System error.	Contact Customer Service.

* After completing a brewing cycle, if you want to brew another round of coffee without unplugging the appliance, open the Filter Holder, remove any coffee residue in the Filter or paper filter, and close the Filter Holder.

PowerXL
products that excel

SMART BREW

Money-Back Guarantee

The PowerXL® Smart Brew is covered by a 90-day money-back guarantee. If you are not 100% satisfied with your product, return the product and request a replacement product or refund. Proof of purchase is required. Refunds will include the purchase price, less processing and handling. Follow the instructions in the Return Policy below to request a replacement or refund.

Replacement Guarantee Policy

Our products, when purchased from an authorized retailer, include a one-year replacement guarantee if your product or component part does not perform as expected, the guarantee extends only to the original purchaser and is not transferable. If you experience an issue with one of our products within one year of purchase, return the product or the component part for replacement with a functionally equivalent new product or part. The original proof of purchase is required, and you are responsible to pay to return the appliance to us. In the event a replacement appliance is issued, the guarantee coverage ends six months following the receipt date of the replacement appliance or the remainder of the existing guarantee, whichever is later. Empower Brands, LLC reserves the right to replace the appliance with one of equal or greater value.

Return Policy

If, for any reason, you would like to replace or return the product under the money-back guarantee, your order number can be used as the return merchandise authorization number (RMA). If the product was purchased in a retail store, return the product to the store or use "RETAIL" as the RMA. Return your product to the address provided below for a replacement, which will incur no additional processing and handling fees, or for the refund of your purchase price, less processing and handling. You are responsible for the cost of returning the product. You can locate your order number at www.customerstatus.com. You can call customer service at 973-287-5106 for any additional questions. Pack the product carefully and include in the package a note with (1) your name, (2) mailing address, (3) phone number, (4) email address, (5) reason for return, and (6) proof of purchase or order number, and (7) specify on the note whether you are requesting a refund or replacement. Write the RMA on the outside of the package.

Send the product to the following return address:

PowerXL Smart Brew
Empower Brands, LLC
500 Returns Road
Wallingford, CT 06495

If the replacement or refund request has not been acknowledged after two weeks, please contact Customer Service at 973-287-5106.

Refund

Refunds requested within the money-back guarantee timeframe will be issued to the payment method used at purchase if the item was purchased directly from Empower Brands, LLC. If the item was purchased from an authorized retailer, proof of purchase is required, and a check will be issued for the item and sales tax amount. Processing and handling fees are non-refundable.

PowerXL
products that excel

SMART BREW

We are very proud of the design and quality of our
PowerXL® Smart Brew

This product has been manufactured to the highest standards. Should you have any questions, our friendly customer service staff is here to help you.

To contact us, email us at **info@tvcustomerinfo.com**
or call 973-287-5106.

Distributed by:
Empower Brands, LLC
Middleton, WI 53562
© 2023 Empower Brands, LLC
PXL_SB_IB_ENG_V3221206

